

Replacing the RECERBO PC Board

Opening the Inverter

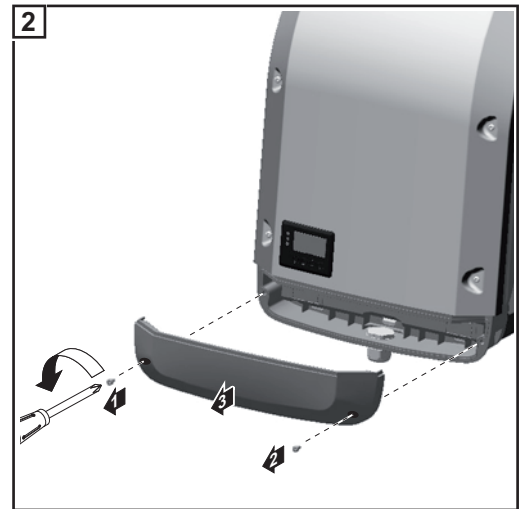

3 Disconnect all available DATCOM components from the inverter

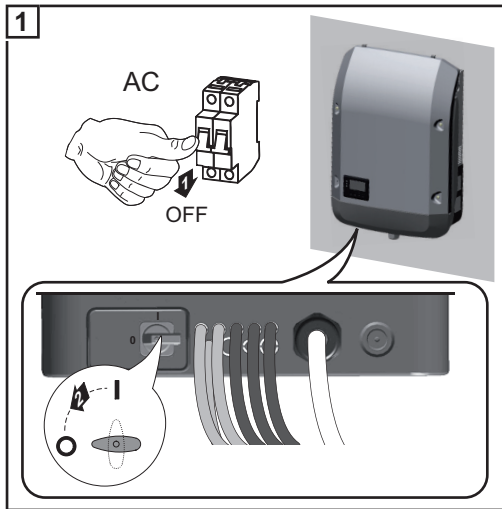
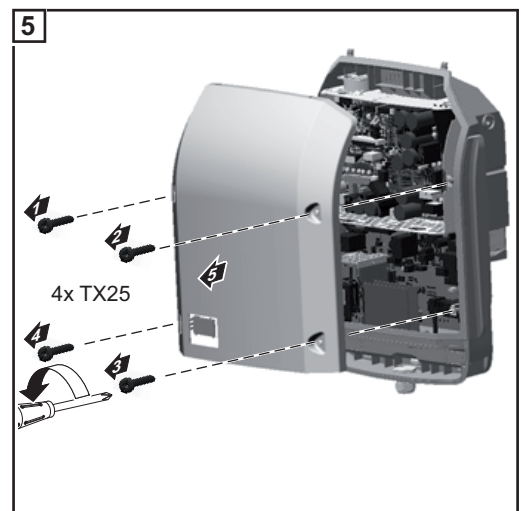
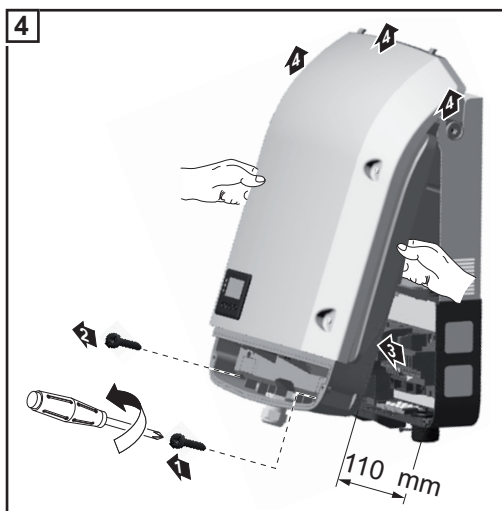

EN

Removing the PC Board

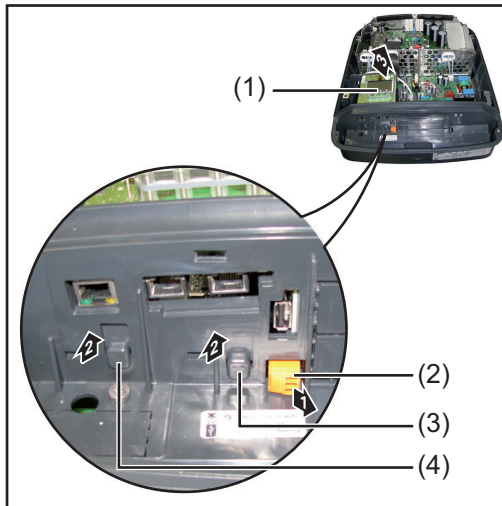

- 1 Remove the plug (2) using a small slotted screwdriver
- 2 Slide up the PC board brackets (3) and (4) together with the RECERBO PC board (1)
- 3 Take out the RECERBO PC board towards inverter top

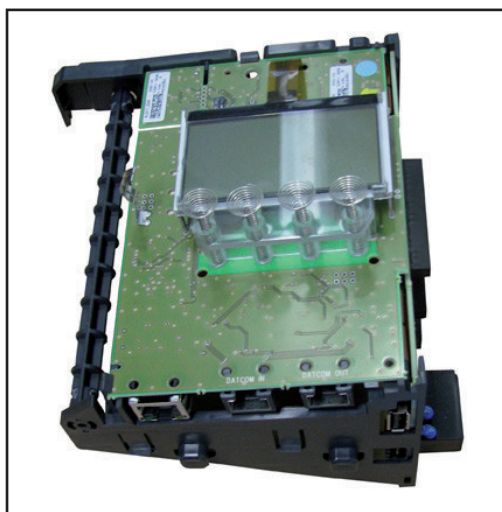

Disassembled RECERBO PC board with mounting support

Connecting the Memory PC Board

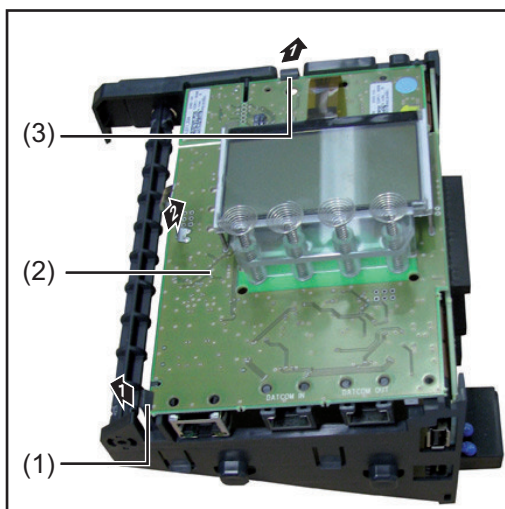

- 1 Push clamping devices (1) and (3) outwards
- 2 Swing out the RECERBO PC board (2) from the mounting support



CAUTION! Danger of inverter-damage due to connecting an improper memory PC board.

Connecting an improper memory PC board may cause overheating of several electronic components. This could cause thermal damage which can in turn lead to fires.

When connecting a memory PC board, make sure that the power limit of the memory PC board corresponds to the power class of the inverter:

For Fronius Galvo 1.5 and 2.0 only use memory PC boards with a power limit ≤ 2.0 kW!

For Fronius Galvo 2.5, 3.0 and 3.1 only use memory PC boards with a power limit > 2.0 kW!

In the case of replacement consider and compare inverter rating plates!

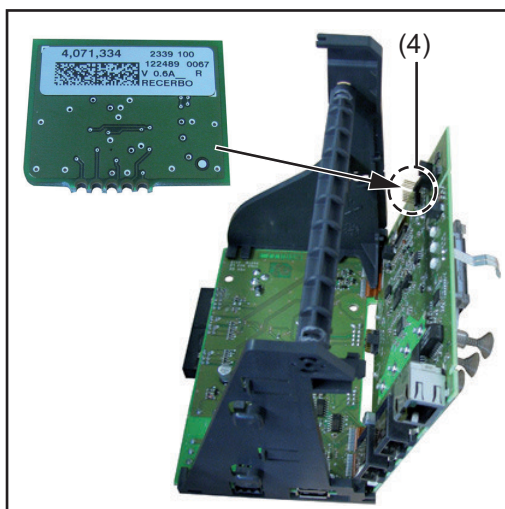

IMPORTANT! When connecting the memory PC board, make sure that all pins of the RECERBO PC board are positioned properly in appropriate connection sockets of the memory PC board.

- 3 Connect the memory PC board to the pins (4) of the RECERBO PC board

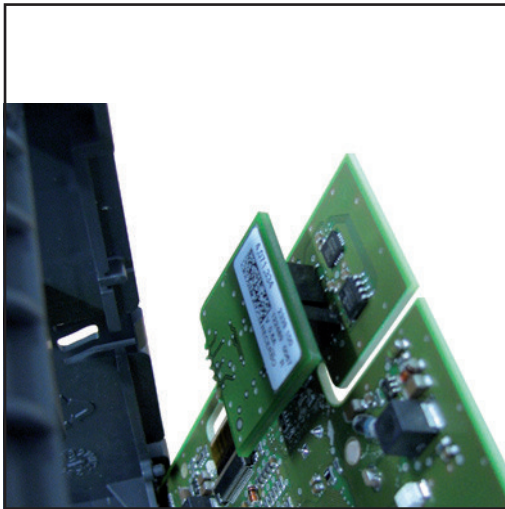

RECERBO PC board with connected memory PC board

IMPORTANT! The memory PC board connected to the pins (4) has priority over a possibly still existing memory PC board of the RECERBO PC board. Thus the memory PC board connected to the pins (4) presets the set data, the power data and the country setup for the inverter.

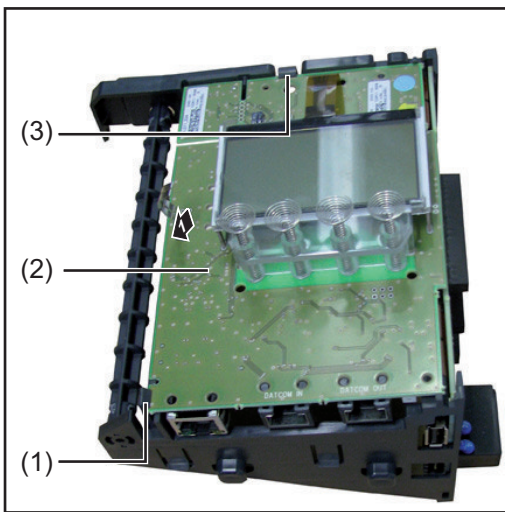

- 4 Swing the RECERBO PC board (2) back into the mounting support and let the clamping devices (1) and (3) snap in

Installing PC Board

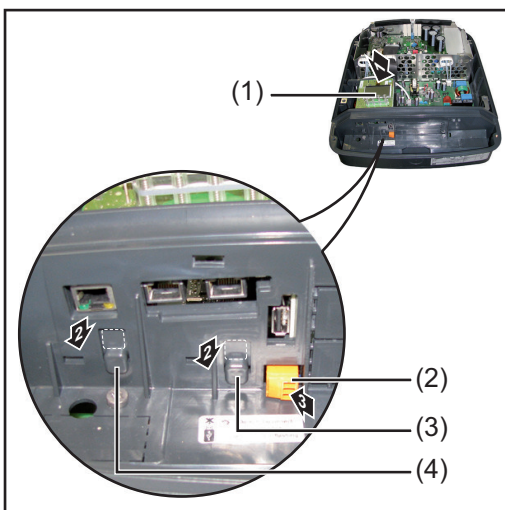

- 1 Insert the RECERBO PC board into the inverter towards inverter bottom. Insert the PC board brackets (3) and (4) into the foreseen holes.
- 2 Push down the PC board brackets (3) and (4) together with the RECERBO PC board (1) up to stop
- 3 Connect the plug (2)

Closing the In-verter

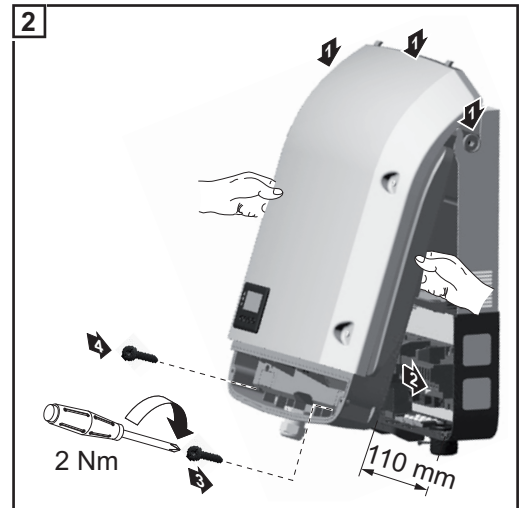
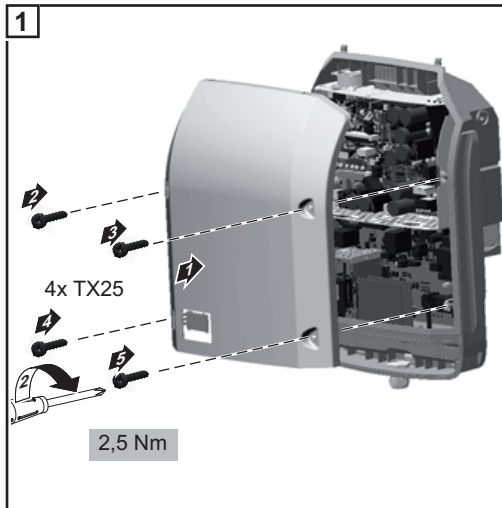

3 Reconnect all available DATCOM components to the inverter

